

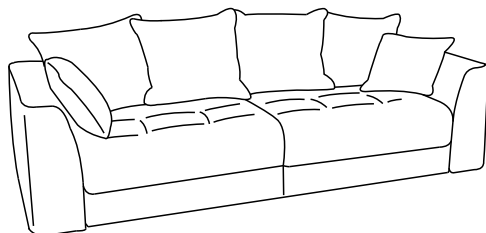

Инструкция по сборке мебели
Furniture assembly instructions

Диван-кровать Монако/ Sofa bed Monaco



**Диван-кровать угловой Монако/
Corner sofa bed Monaco**

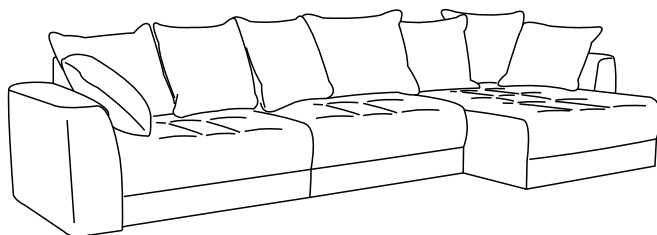

**Диван-кровать Монако П-образный/
Sofa bed Monaco U-shaped**

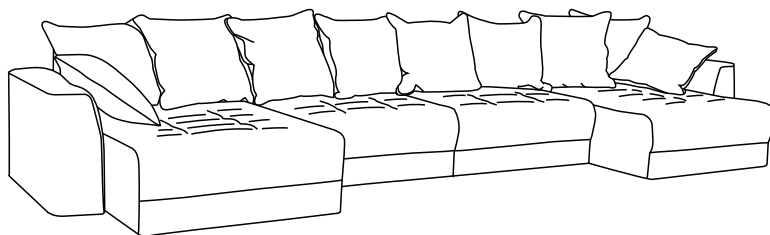

TP TC 025/2012

Схема сборки прямого дивана/ Assembly scheme of straight sofa

Схемы сборки углового и П-образного дивана
смотрите со стр.7/ Assembly scheme of corner and U-shaped sofa see p.7

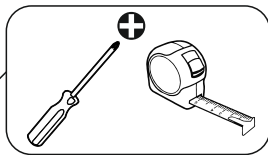
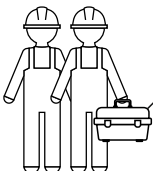
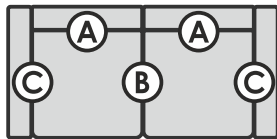

Комплектовочная ведомость прямого дивана Packing list of straight sofa

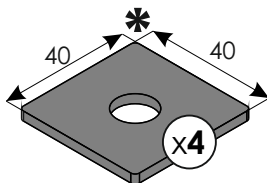
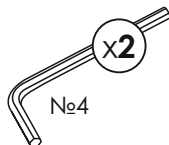
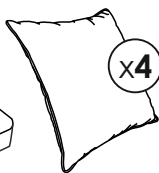
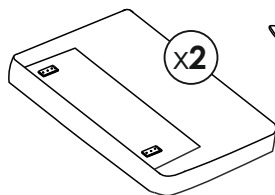
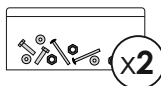
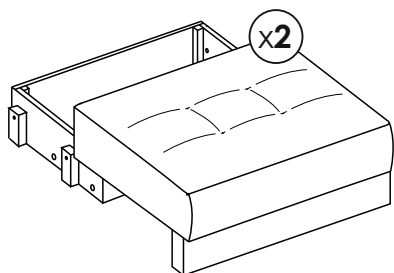

* для облегчения
раскладывания
(при необходимости)

* to facilitate the unfolding process

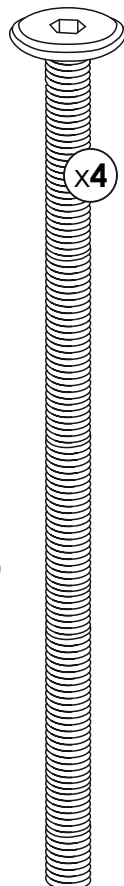

M6*110

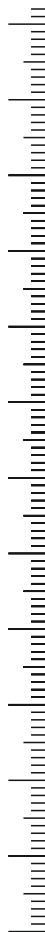

Подлокотники (для прямого дивана Монако)

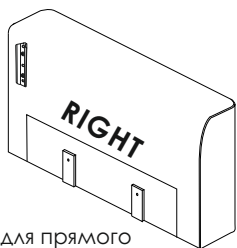
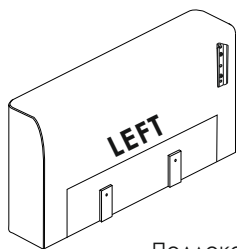

Подлокотник для прямого дивана **с зацепом**

Armrest with straight sofa with wedge lock

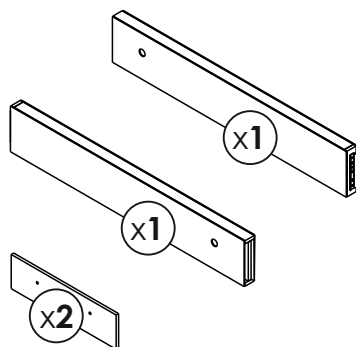
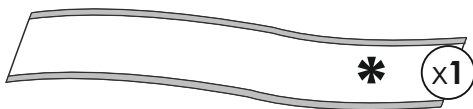
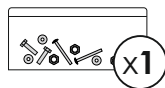

*Чехол, фальш-спинка **ТОЛЬКО ДЛЯ ПРЯМОГО ДИВАНА**

*Cover, false backrest only for straight sofa

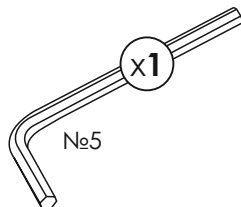
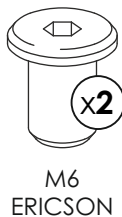
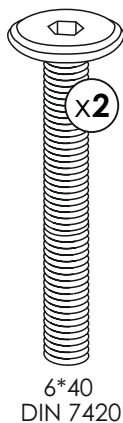
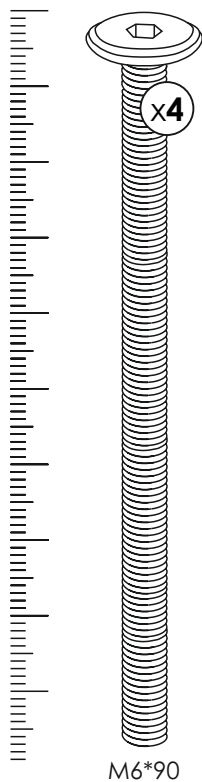

A

Сборка прямого дивана Монако/ Straight sofa Monaco assembly

Установка откидной спинки/ Installing folding backrest

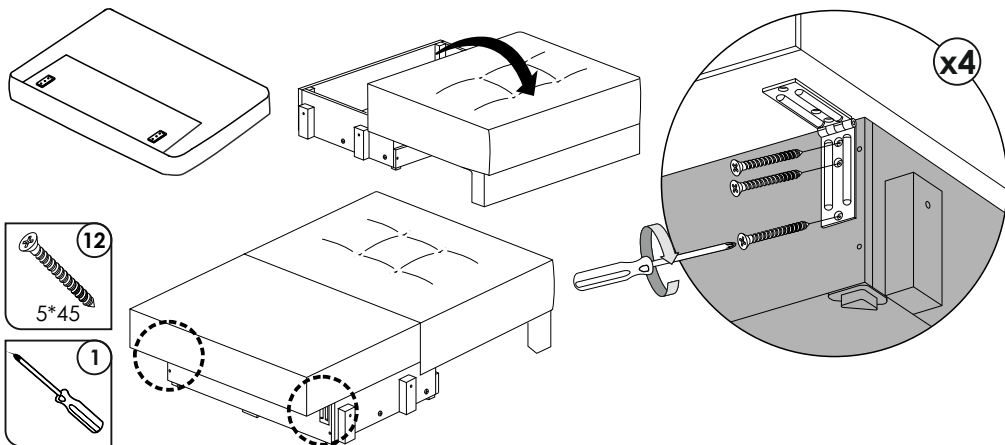
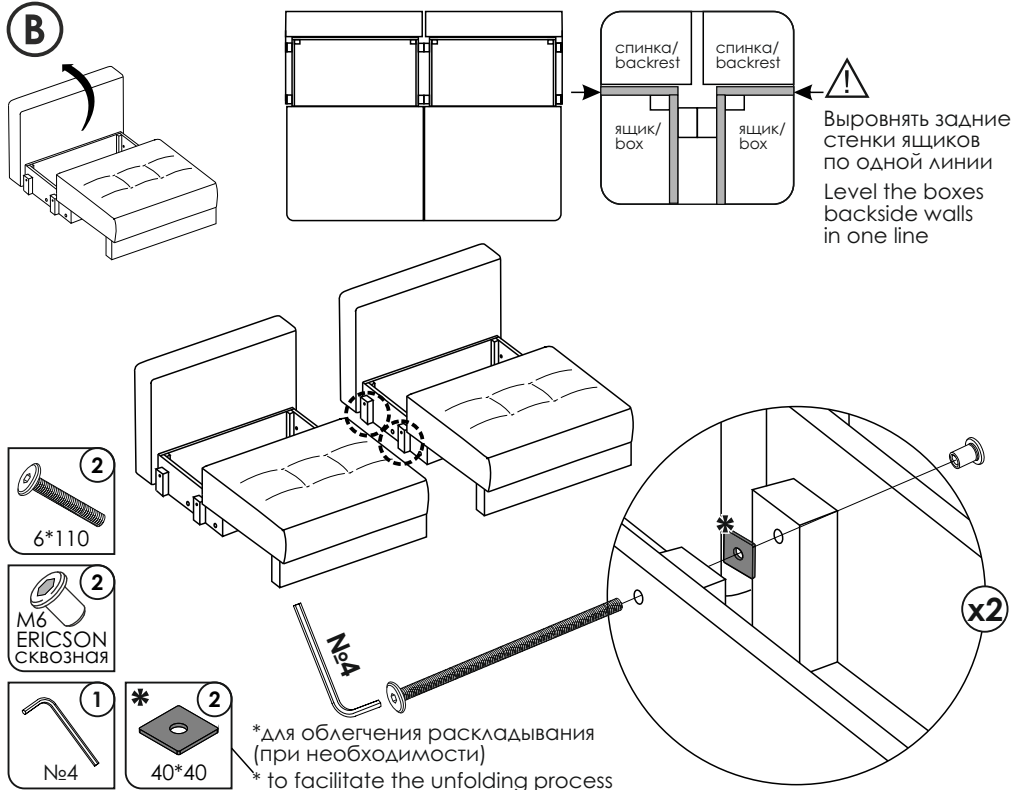
**B**

©

Установка подлокотника/ Installing armrest

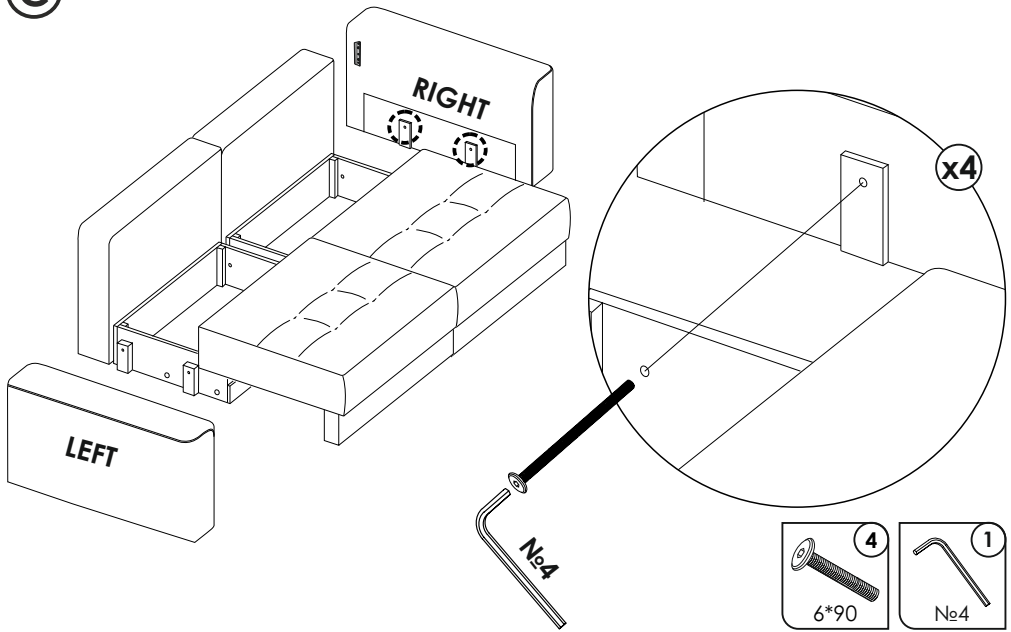

Сборка фальш - спинки/ False backrest assembly

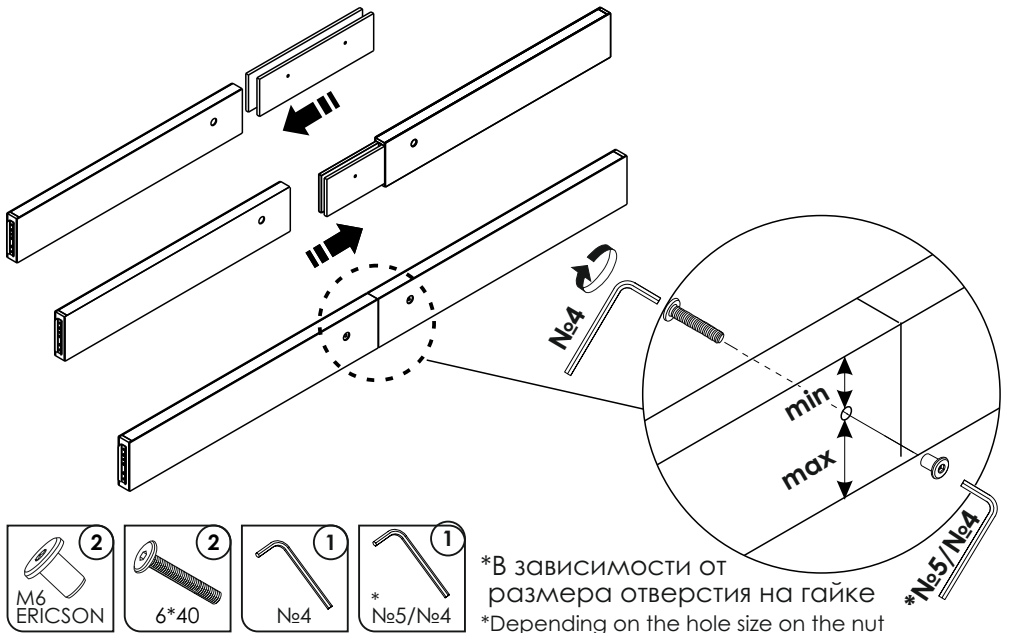

Чехление и установка фальш - спинки/ Covering and installing false backrest

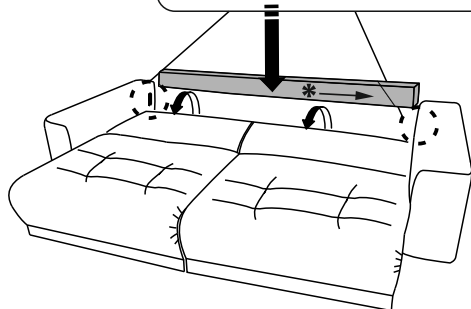
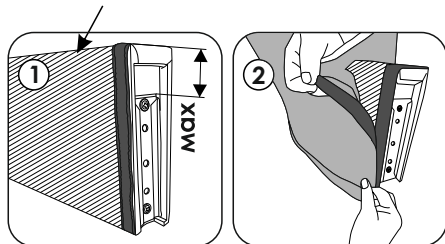
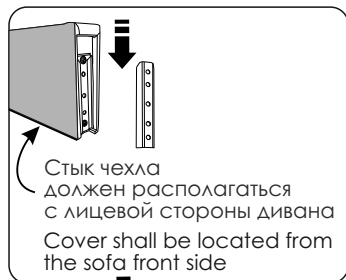
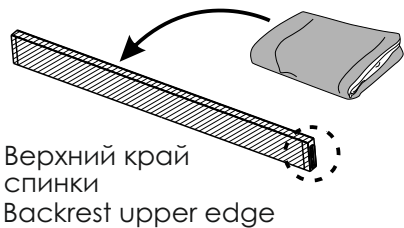

Порядок трансформации/ Transformation sequence

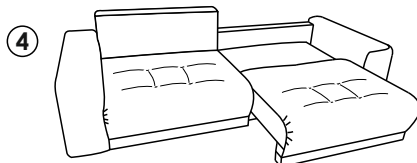
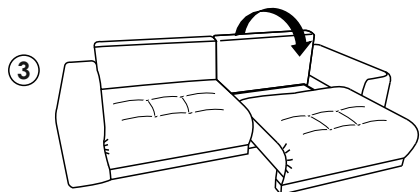
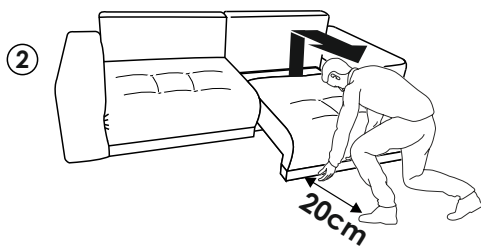
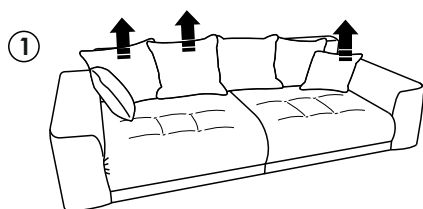

Схемы сборки возможных конфигураций дивана с канапе/ Assembly schemes of sofa with canape possible configurations

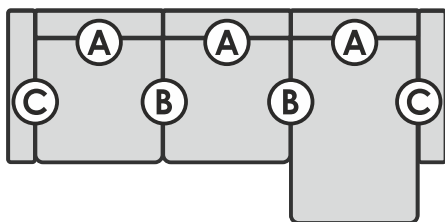
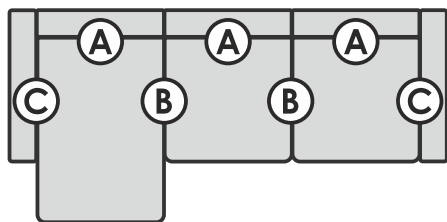

П - образный диван/ U-shaped sofa

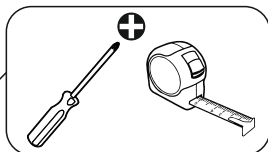
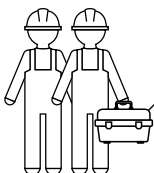
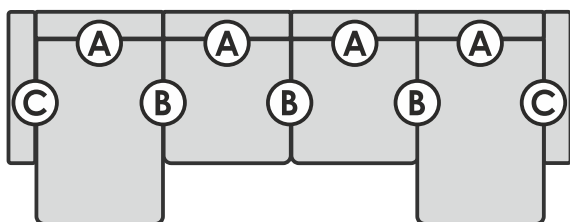

Комплектовочная ведомость/ Packing list

Центральные секции/
Center section

Секция канапе/
Section with canape

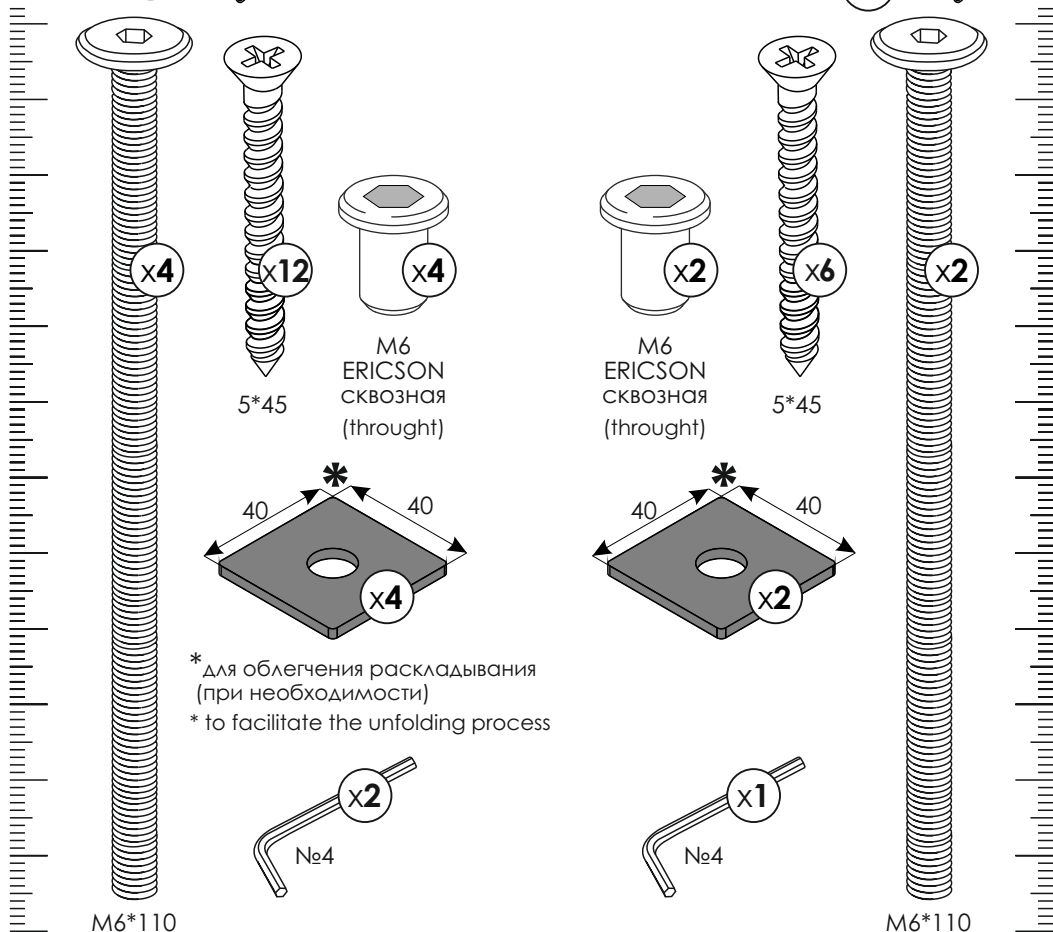
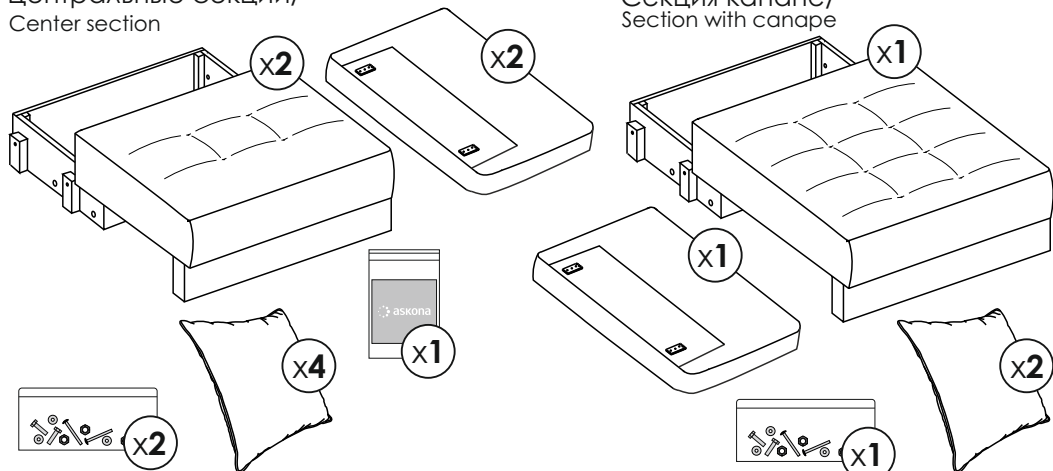

M6*110

M6*110

* для облегчения раскладывания
(при необходимости)
* to facilitate the unfolding process

Подлокотники (для углового дивана
 подлокотники без зацепов)/
 Armrest (for corner sofa
 armrests without wedge locks)

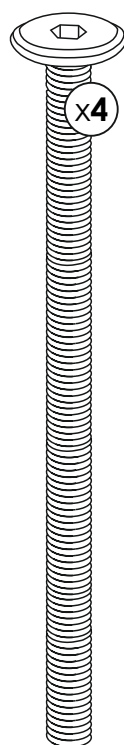
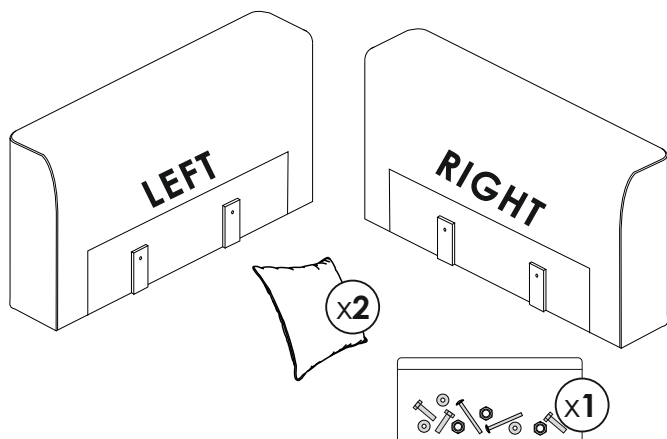

M6*90

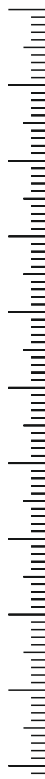

A

Установка откидной спинки/ Installing folding backrest

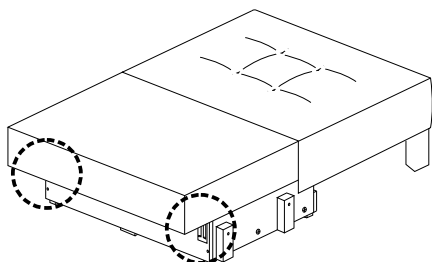
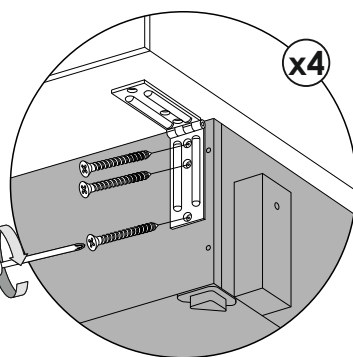
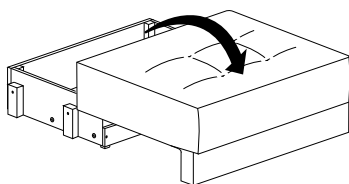
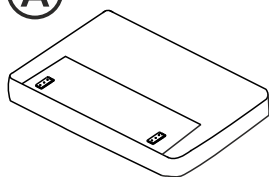

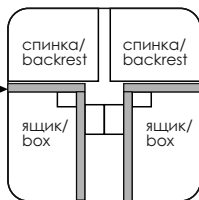
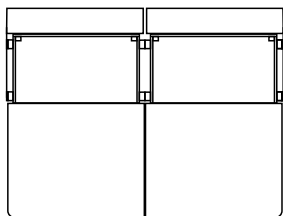
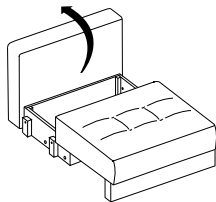
B

Вывернуть задние
стенки ящиков
по одной линии
Level the boxes
backside walls
in one line

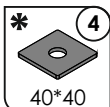
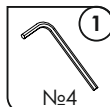
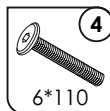

*для облегчения раскладывания
(при необходимости)
*to facilitate the unfolding process

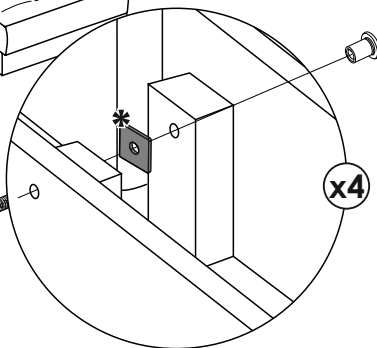
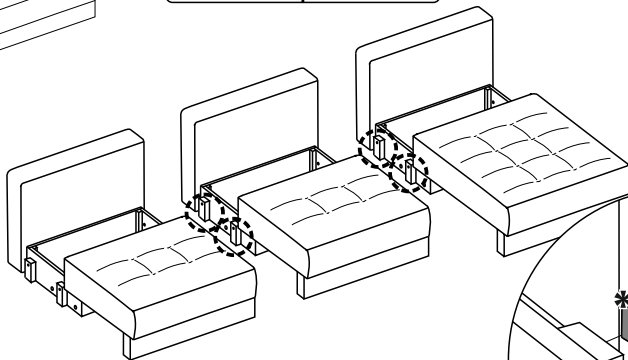

Установка подлокотника/ Installing armrest

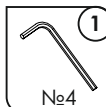
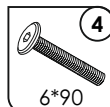
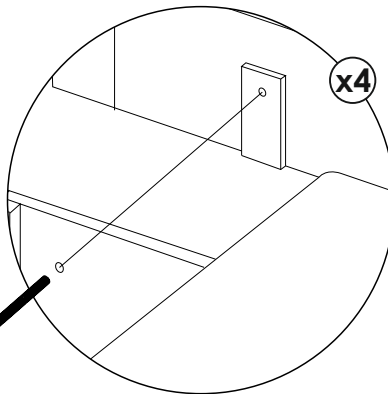
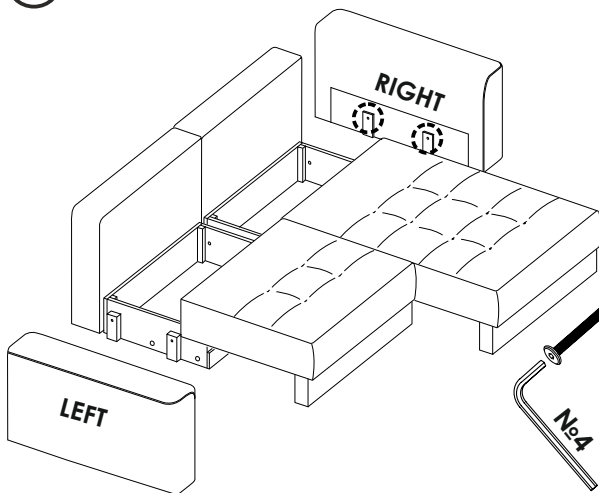
C

Порядок трансформации/ Transformation sequence

①

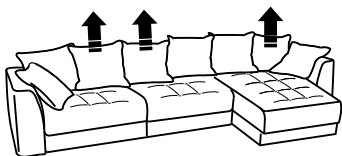

②

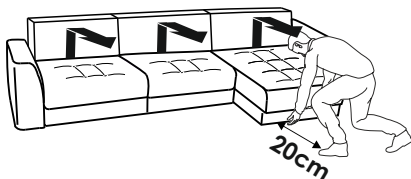

③

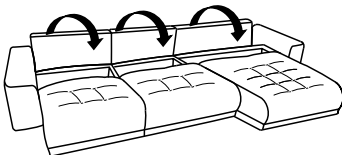

④

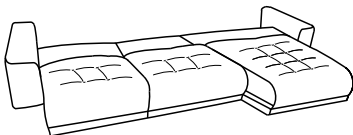

Общие рекомендации/ General recommendations

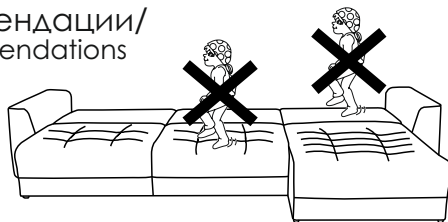
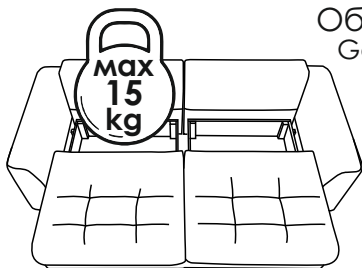

Нельзя садиться и вставать на край спинки/
It is prohibited to sit down and step on the backrest edge

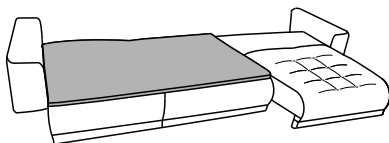
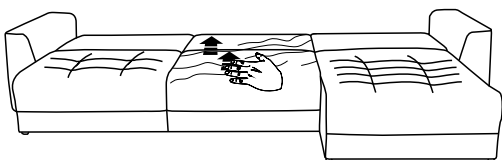
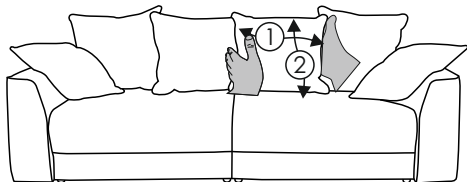
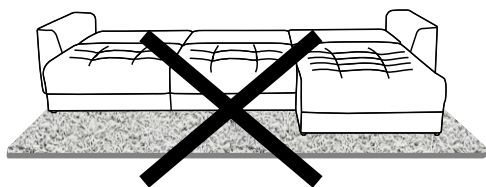
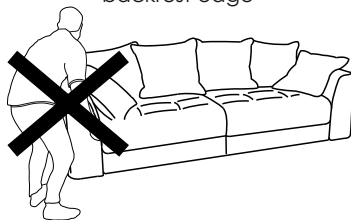
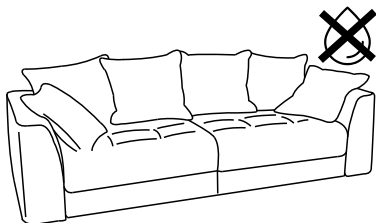

В разложенном положении рекомендуется использовать топпер/
It is recommended to use a topper in unfolded position

